

SKU #	1936-DR24V-27K	1936-DR24V-30K	1936-DR24V-40K
Power Per Foot	3.6W /ft	3.6W / ft	3.6W /ft
Input	24V DC	24V DC	24 VDC
Color Temperture	2700K	3000K	4000K
Lumen Per Foot	348 lm	360 lm	374 lm
CRI	90 >	90 >	90 >
PCB Width	10 mm	10 mm	10 mm
Strip Length	16.4"	16.4"	16.4"
Cutting Length	1.65"	1.65"	1.65"
Working Temp	-4~104	-4~104	-4~104
IP Rating	Dry/ Damp IP20	Dry/ Damp IP20	Dry/ Damp IP20
Standards	UL	UL	UL

## Features

- Chips-on-board design
- 180° beam angle with wider emitting
- Double layer PCB for better flexibility and heat dissipation
- The slim and flexible design of COB tape allows for easy installation in tight spaces or curved surfaces
- Premium COB tapes offer a high CRI, ensuring accurate and vibrant color representation
- COB tape utilizes advanced Chip on Board technology to provide high-intensity illumination
- lasting tens of thousands of hours, reducing the need for frequent replacement and maintenance

## Accessories

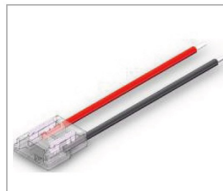

Power feed  
AD-SC-2PIN-10MM-B

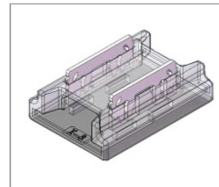

Strip To Strip  
AD-SC-2PIN-10MM-H

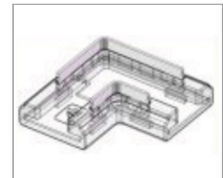

L Connector  
AS-SC-2PIN-10MM-L

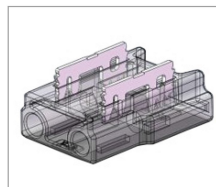

Strip To Wire

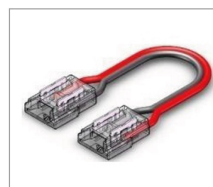

Strip To Strip Turn



Male / Female Barrel

